



Solutions For Your Hydraulic Needs

PRODUCT CATALOG

2026



HYDRAULIC QUICK COUPLERS

NEW



FACTORY DIRECT

Table of Contents

XINGYU



Company profile



Hydraulic cylinder

1. How to order
2. Hydraulic cylinder
3. Standard cylinder
4. Nonstandard oil cylinder
5. Multi-stage oil cylinder
6. HOB oil cylinder



Powerunit

1. DC power unit
2. Explosion-proof power unit
3. AC power unit
4. Power unit electronic control



Hydraulic system

1. Servo motor hydraulic system
2. Explosion-proof motor hydraulic system
3. Standard hydraulic system
4. Non-standard hydraulic system



Hydraulic accessories

1. Fluid pump
2. Electrical machinery
3. Hydraulic valve
4. Valve block
5. Air cooler
6. Water cooler
7. Hydraulic motor
8. Pump casing
9. Return oil filter
10. motor pump set
11. electromagnetic coil
12. valve assembly
13. Electric control box
14. fuel tank cap
15. Earring back
16. Oil-absorbing filter
17. Accumulator
18. oil seal





COMPANY PROFILE



Shandong Linyi XINGYU Hydraulics Co., Ltd. is a professional manufacturer of hydraulic cylinders, power units, hydraulic systems, and hydraulic accessories. We are dedicated to delivering complete hydraulic solutions for industrial hydraulic equipment manufacturers worldwide.

Our hydraulic products are widely applied across key industries: automation equipment, agricultural machinery, material handling equipment, aerial work platforms, waste management machinery, and special vehicles.

We offer a full range of hydraulic cylinders, including HSG engineering cylinders, welded cylinders, tie-rod cylinders, telescopic cylinders, electric cylinders, and servo systems. We also excel in non-standard custom hydraulic solutions to meet unique project requirements.

At XINGYU Hydraulics, we pride ourselves on efficient, clear communication. Our team consists of skilled engineers, experienced technicians, and advanced production specialists, supported by a responsive customer service team. Together, we build professional, fast, and reliable partnerships with global clients.

Guided by our quality policy of "Integrity, Mission, Innovation," we manufacture high-performance hydraulic products. We are committed to providing stable, high-quality hydraulic solutions and comprehensive after-sales service, leveraging our technical expertise and operational resources to maximize customer value.

Quality first, customer first

Model Description

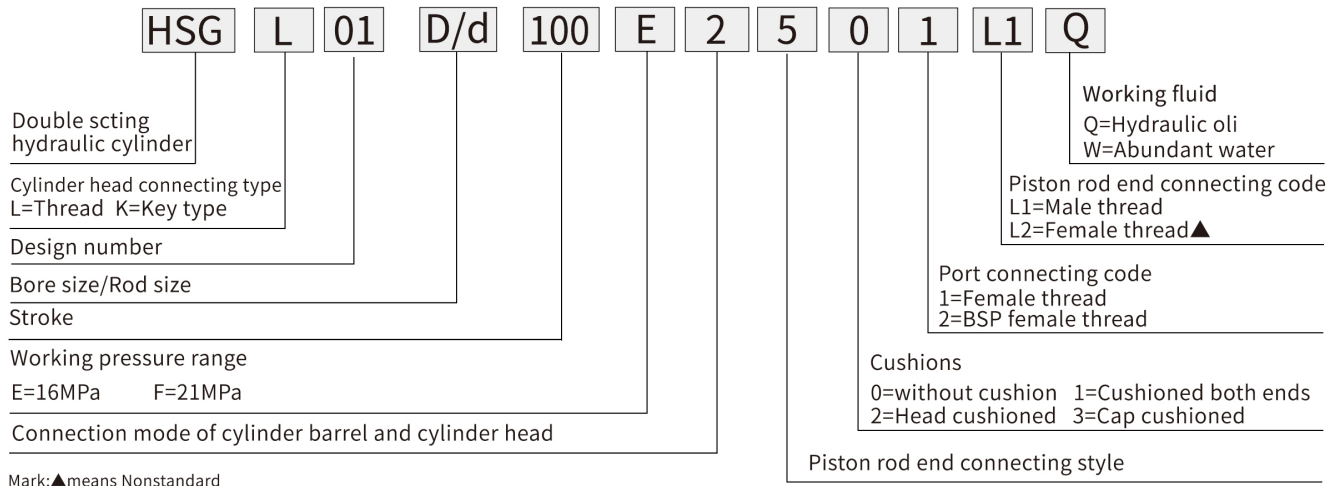

Connection mode of cylinder barrel and cylinder head

Connection method	Remarks
1=Head fixed eye with bushing	
2=Head fixed eye with spherical bearing	
3=Trunnion	
4=Head flange	
5=Intermediate flange	
6=Cap flange	

Piston rod end connecting style

Connection method	Remarks
1=Male thread	
2=Female thread	缸径Bore≥φ63
3=Male thread rod+fixed eye with bushing	
4=Female thread +fixed eye with bushing	缸径Bore≥φ63
5=Male thread +fixed eye with spherical bearing	
6=Female thread +fixed eye with spherical bearing	缸径Bore≥φ63
7=Welded fixed eye with bushing	
8=Welded fixed eye with spherical bearing	

XINGYU™ WT WELDED CYLINDERS

MODEL DESCRIPTION

- **Intended Use:** Double-acting applications
- **Temp:** -40°F to 230°F
- **Piston:** Ductile iron ASTM A536 65-45-12
- **Gland:** Ductile iron, drilled oil passages - ASTM A536 65-45-12
- **Tube:** Precision honed steel
- **Rod:** Hard chrome plated
- **End Mounts:** Ductile iron female clevises with pins and clips included
- **Tube Seals:** Buna O-ring
- **Rod Seal:** Deep polypak with B lip design
- **Rod Wiper:** Urethane, snap-in
- **Piston Seal:** Hallite 755 prolonged wear resistance with wear ring
- Painted Black
- **1-year limited warranty**



Note: 1.14" length of thread on rod end (no room to adjust). 3.15" length of thread for 8" and 16" ASAE (do not adjust below 1.625 length of the end)

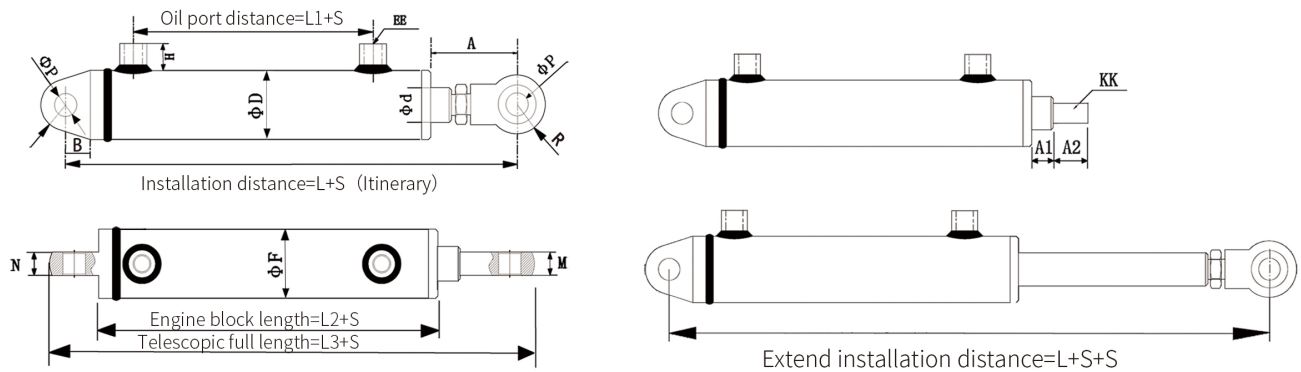

(HSG dimensions)

φ D (Cylinder bore)	φ d (Rod diameter)	EE (Oil port)	φ P (Aperture)		φ F (Cylinder outer diameter)	M	N	R	R1
φ 40	φ 25	M18*1.5	20	220	50	25	20	25	22
φ 50	φ 28	M18*1.5	20	230	60	25	25	28	22
φ 63	φ 35	M18*1.5	30	270	73	35	30	35	35
φ 80	φ 50	M18*1.5	40	350	92	45	45	45	45
φ 100	φ 60	M22*1.5	50	400	114	60	60	56	55
φ 125	φ 70	M22*1.5	50	435	145	60	60	56	60
φ 140	φ 80	M22*1.5	50	455	168	60	60	60	60

φ D (Cylinder bore)	A	B	A1	A2	L1	L2 (Long)	L3 (Retract long)	KK	H
φ 40	85	35	15	35	40	100	270	M16*1.5	21
φ 50	85	35	15	35	55	110	285	M22*1.5	21
φ 63	100	40	20	38	65	130	335	M27*1.5	21
φ 80	130	55	38	45	70	165	435	M33*2	21
φ 100	135	75	23	48	70	190	510	M42*2	21
φ 125	150	75	42	48	80	210	535	M42*2	21
φ 140	165	80	25	48	80	210	570	M60*2	21

[Piston Rod End Is Male Thread Connecting]

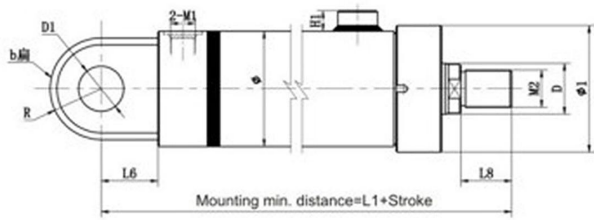

1.Fixed Eye(Kep Type)

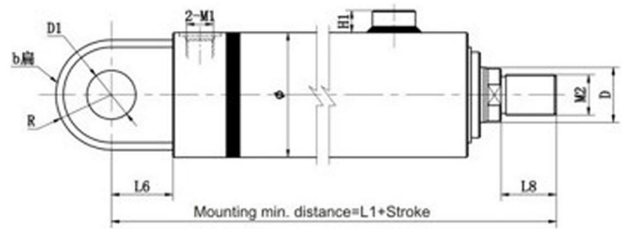

2.Fixed Eye(Thread)



3.Trunnion

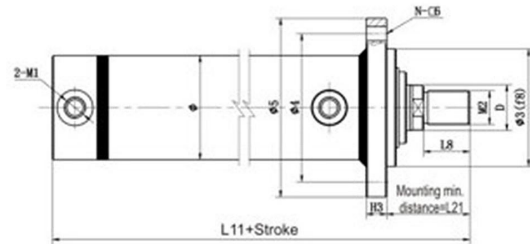

4.Head Flange

Remark:

The stroke must be more than the minimum "S1" number when the trunnion and intermediate flange mounting is selected.

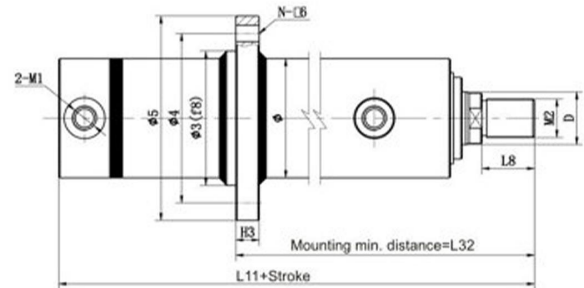

5.Intermediate Flange

Bore	Φ	d			D1	R/b	L6	M2	L8	L1	2-M1	H1	Φ1
		Dψ=1.33	Dψ=1.46	Dψ=2									
40	55	20	22	25	20 / GE20ES	25	30	M18x2	25	230	M14 × 1.5	15	65
50	65	25	28	32	30 / GE30ES	35	40	M24x2	30	250	M18 × 1.5	15	75
63	80	32	35	45	30 / GE30ES	35	40	M24x2	30	260	M18 × 1.5	15	90
80	100	40	45	55	40 / GE40ES	45	50	M39x3	50	317	M22 × 1.5	18	110
90	114	45	50	63	40 / GE40ES	45	50	M39x3	50	312	M22 × 1.5	18	—
100	125	50	55	70	50 / GE50ES	60	65	M50x3	60	352	M27 × 2	20	—
110	140	55	63	80	50 / GE50ES	60	65	M50x3	60	367	M27 × 2	20	—
125	152	63	70	90	50 / GE50ES	60	65	M50x3	60	372	M27 × 2	20	—
140	166	70	80	100	60 / GE60ES	70	75	M64x3	75	418	M27 × 2	20	—
150	178	75	85	105	60 / GE60ES	70	75	M64x3	75	428	M33 × 2	22	—
160	194	80	90	110	60 / GE60ES	70	75	M64x3	75	438	M33 × 2	22	—
180	219	90	100	125	70 / GE70ES	80	85	M80x3	85	483	M42 × 2	25	—
200	245	100	110	140	80 / GE80ES	95	95	M90x3	95	513	M42 × 2	25	—
220	273	110	125	160	90 / GE90ES	102	105	M100x3	105	565	M42 × 2	25	—
250	299	125	140	180	100 / GE100ES	120	120	M110x4	115	619	M42 × 2	25	—

Bore Φ	L15	L16	L11	$\Phi 3$	$\Phi 4$	$\Phi 5$	H3	L21	N- $\Phi 6$	L31	L32	S1
80	125	185	292	115	145	175	20	98	8- $\Phi 13.5$	>230<175+S	>215<205+S	55
90	140	200	275	130	160	190	20	89	8- $\Phi 13.5$	>230<170+S	>215<200+S	60
100	155	230	322	145	180	210	20	100	8- $\Phi 18$	>260<180+S	>240<220+S	80
110	170	245	337	160	195	225	22	102	8- $\Phi 18$	>265<195+S	>245<230+S	70
125	185	260	342	175	210	240	22	100	10- $\Phi 18$	>255<200+S	>235<240+S	55
140	200	290	383	190	225	260	24	121	10- $\Phi 20$	>305<225+S	>291<276+S	80
150	215	305	393	205	245	285	26	122	10- $\Phi 22$	>315<235+S	>295<275+S	80
160	230	320	403	220	260	300	28	122	10- $\Phi 22$	>315<245+S	>295<285+S	70
180	255	360	443	245	285	325	30	133	10- $\Phi 24$	>350<260+S	>325<305+S	90
200	285	405	463	275	320	365	32	146	10- $\Phi 26$	>370<250+S	>345<320+S	100
220	320	466	508	305	355	405	34	160	10- $\Phi 29$	-	-	100
250	350	500	552	330	390	450	36	176	12- $\Phi 32$	-	-	105

(Piston Rod End Is Female Thread Connecting)

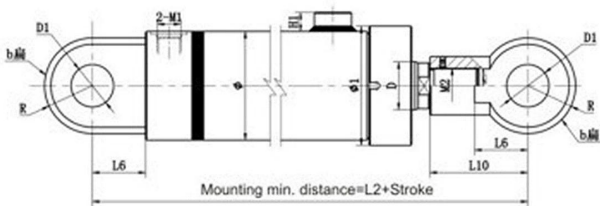

1.Fixed Eye(Kep Type)

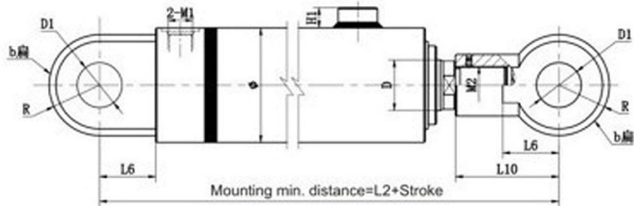

2.Fixed Eye(Thread)

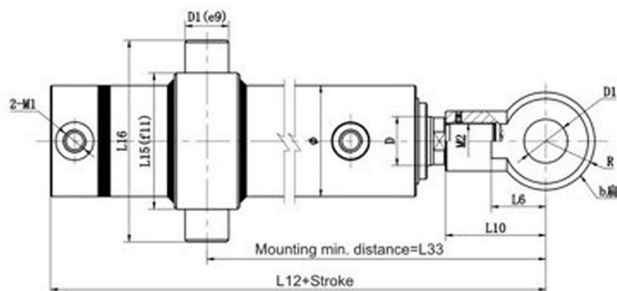

3.Trunnion

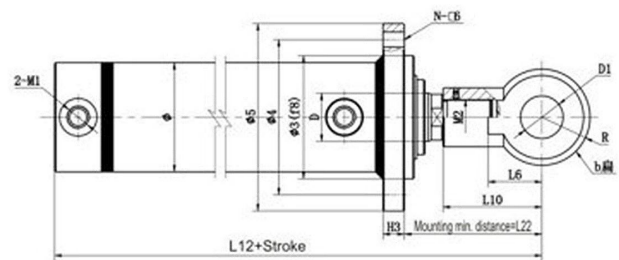

4.Head Flange

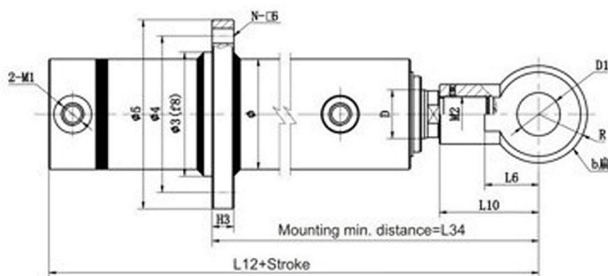

5.Intermediate Flange

Remark:

The stroke must be more than the minimum "S1" number when the trunnion and intermediate flange mounting is selected.

Bore	Φ	d			D1	R/b	L6	M2	L10	L2	2-M1	H1	Φ1
		Dψ=1.33	Dψ=1.46	Dψ=2									
40	55	20	22	25	20/GE20ES	25	30	M18x2	65	270+S	M14×1.5	15	65
50	65	25	28	32	30/GE30ES	35	40	M24x2	75	295+S	M18×1.5	15	75
63	80	32	35	45	30/GE30ES	35	40	M24x2	75	305+S	M18×1.5	15	90
80	100	40	45	55	40/GE40ES	45	50	M39x3	105	372+S	M22×1.5	18	110
90	114	45	50	63	40/GE40ES	45	50	M39x3	105	367+S	M22×1.5	18	—
100	125	50	55	70	50/GE50ES	60	65	M50x3	135	427+S	M27×2	20	—
110	140	55	63	80	50/GE50ES	60	65	M50x3	135	442+S	M27×2	20	—
125	152	63	70	90	50/GE50ES	60	65	M50x3	135	447+S	M27×2	20	—
140	166	70	80	100	60/GE60ES	70	75	M64x3	170	513+S	M27×2	20	—
150	178	75	85	105	60/GE60ES	70	75	M64x3	170	523+S	M33×2	22	—
160	194	80	90	110	60/GE60ES	70	75	M64x3	170	533+S	M33×2	22	—
180	219	90	100	125	70/GE70ES	80	85	M80x3	195	593+S	M42×2	25	—
200	245	100	110	140	80/GE80ES	90	95	M90x3	210	628+S	M42×2	25	—
220	273	110	125	160	90/GE90ES	100	105	M100x3	250	710+S	M42×2	25	—
250	299	125	170	180	100/GE100ES	110	120	M110x4	275	779+S	M42×2	25	—

Bore Φ	L15	L16	L12	Φ3	Φ4	Φ5	H3	L22	N-Φ6	L33	L34	S1
80	125	185	347	115	145	175	20	153	8-Φ13.5	>285<230+S	>265<260+S	55
90	140	200	330	130	160	190	20	144	8-Φ13.5	>285<225+S	>270<255+S	60
100	155	230	397	145	180	210	20	175	8-Φ18	>335<255+S	>315<295+S	80
110	170	245	412	160	195	225	22	177	8-Φ18	>340<270+S	>320<305+S	70
125	185	260	417	175	210	240	22	175	10-Φ18	>330<275+S	>320<315+S	55
140	200	290	478	190	225	260	24	216	10-Φ20	>400<320+S	>375<371+S	80
150	215	305	488	205	245	285	26	217	10-Φ22	>410<330+S	>390<370+S	80
160	230	320	498	220	260	300	28	217	10-Φ22	>410<340+S	>390<380+S	70
180	255	360	553	245	285	325	30	243	10-Φ24	>460<370+S	>435<415+S	90
200	285	405	578	275	320	365	32	261	10-Φ26	>485<365+S	>460<435+S	100
220	320	466	653	305	355	405	34	305	10-Φ29	By custom		100
250	350	500	712	330	390	450	36	336	12-Φ32	By custom		105

XINGYU

HSG Earring Cylinder



[Piston Rod End Is Female Thread Connecting+ Fixed eye]

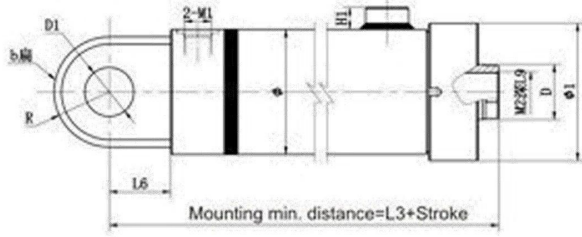

1.Fixed Eye(Kep Type)

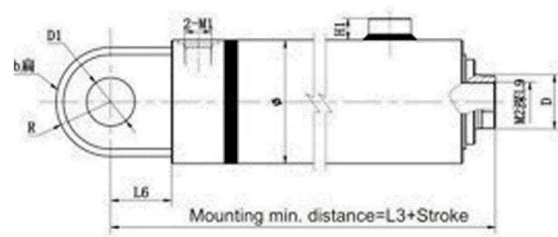

2.Fixed Eye(Thread)

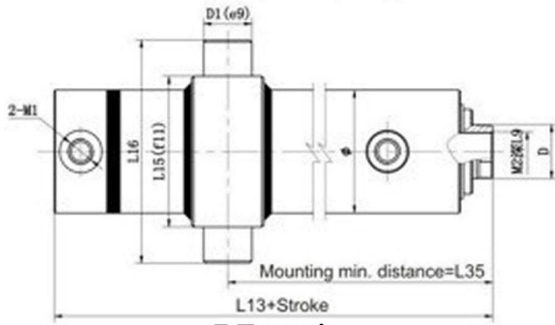

3.Trunnion

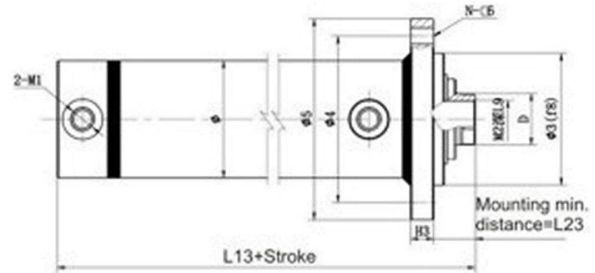

4.Head Flange

Remark:

The stroke must be more than the minimum "S1" number when the trunnion and intermediate flange mounting is selected.

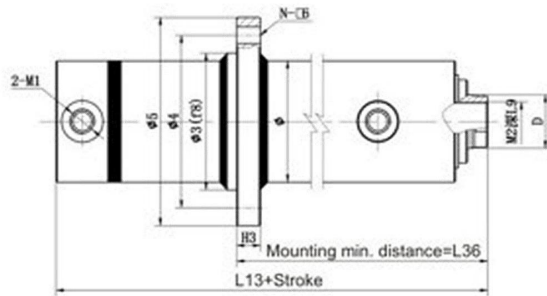

5.Intermediate Flange

Bore	Φ	d			D1	R/b	L6	M2	M3	L9	L3	2-M1	H1	Φ1
		Dψ=1,33	Dψ=1,46	Dψ=2										
40	55		22	25	20 / GE20ES	25	30	M16x1.5		30	205	M14x1.5	15	65
50	65		28	32	30 / GE30ES	35	40	M22x1.5		35	220	M18x1.5	15	75
63	80	32	35	45	30 / GE30ES	35	40	M27x1.5	M24x1.5	40	230	M18x1.5	15	90
80	100	40	45	55	40 / GE40ES	45	50	M33x1.5	M30x1.5	45	267	M22x1.5	18	110
90	114	45	50	63	40 / GE40ES	45	50	M36x2	M33x1.5	45	262	M22x1.5	18	-
100	125	50	55	70	50 / GE50ES	60	65	M42x2	M36x2	50	292	M27x2	20	-
110	140	55	63	80	50 / GE50ES	60	65	M48x2	M42x2	55	307	M27x2	20	-
125	152	63	70	90	50 / GE50ES	60	65	M52x2	M48x2	60	312	M27x2	20	-
140	166	70	80	100	60 / GE60ES	70	75	M60x2	M52x2	65	343	M27x2	20	-
150	178	75	85	105	60 / GE60ES	70	75	M64x2	M60x2	70	353	M33x2	22	-
160	194	80	90	110	60 / GE60ES	70	75	M68x2	M64x2	75	363	M33x2	22	-
180	219	90	100	125	70 / GE70ES	80	85	M76x3	M68x2	85	398	M42x2	25	-
200	245	100	110	140	80 / GE80ES	90	95	M85x3	M76x2	95	418	M42x2	25	-
220	273	110	125	160	90 / GE90ES	100	105	M95x3	M85x3	105	460	M42x2	25	-
250	299	125	170	180	100 / GE100ES	110	120	M105x3	M95x3	115	504	M42x2	25	-

Bore Φ	L15	L16	L13	Φ3	Φ4	Φ5	H3	L23	N-Φ6	L35	L36	S1
80	125	185	242	115	145	175	20	48	8-Φ13.5	>180<125+S	>165<155+S	55
90	140	200	225	130	160	190	20	39	8-Φ13.5	>180<120+S	>165<150+S	60
100	155	230	262	145	180	210	20	40	8-Φ18	>200<120+S	>180<160+S	80
110	170	245	277	160	195	225	22	42	8-Φ18	>205<135+S	>185<170+S	70
125	185	260	282	175	210	240	22	40	10-Φ18	>195<140+S	>185<180+S	55
140	200	290	308	190	225	260	24	46	10-Φ20	>230<150+S	>216<201+S	80
150	215	305	318	205	245	285	26	47	10-Φ22	>240<160+S	>220<200+S	80
160	230	320	328	220	260	300	28	47	10-Φ22	>240<170+S	>220<210+S	70
180	255	360	358	245	285	325	30	48	10-Φ24	>265<175+S	>240<220+S	90
200	285	405	368	275	320	365	32	51	10-Φ26	>275<155+S	>250<225+S	100
220	320	466	403	305	355	405	34	55	10-Φ29	As request		100
250	350	500	437	330	390	450	36	61	12-Φ32			105

Remark:

The stroke must be more than the minimum "S1" number when the trunnion and intermediate flange mounting is selected.

[Piston Rod End Is Female Thread Connecting]

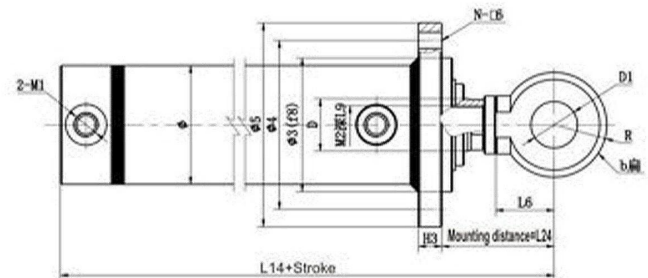
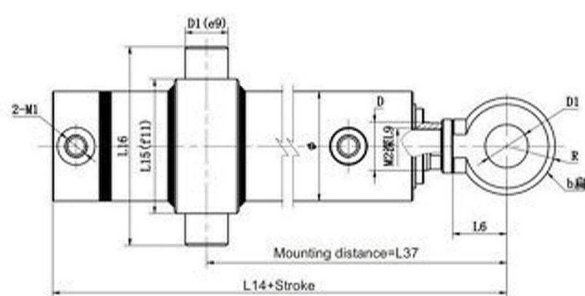
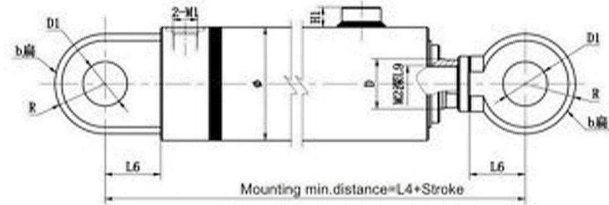
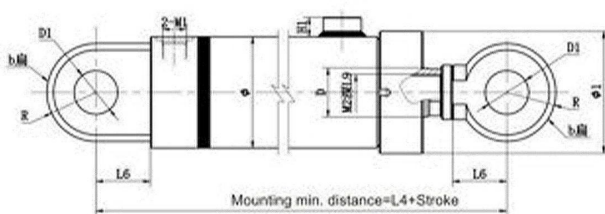

H3

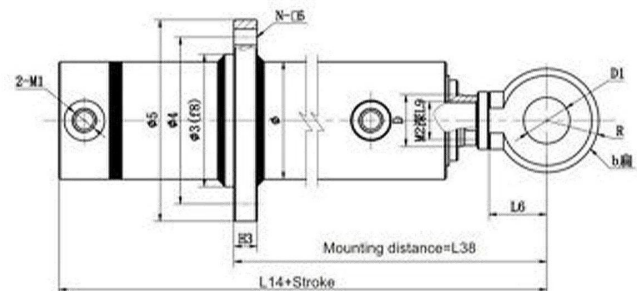

Bore	Φ	d			D1	R/b	L6	M2	M3	L9	L4	2-M1	H1	Φ1
		Dψ=1.33	Dψ=1.46	Dψ=2										
40	55	—	22	25	20 / GE20ES	25	30	Welded fixed eye			235	M14x1.5	15	65
50	65	—	28	32	30 / GE30ES	35	40				260	M18x1.5	15	75
63	80	32	35	45	30 / GE30ES	35	40	M27x1.5	M24x1.5	35	280	M18x1.5	15	90
80	100	40	45	55	40 / GE40ES	45	50	M33x1.5	M30x1.5	40	327	M22x1.5	18	110
90	114	45	50	63	40 / GE40ES	45	50	M36x2	M33x1.5	50	322	M22x1.5	18	—
100	125	50	55	70	50 / GE50ES	60	65	M42x2	M36x2	55	367	M27x2	20	—
110	140	55	63	80	50 / GE50ES	60	65	M48x2	M42x2	60	382	M27x2	20	—
125	152	63	70	90	50 / GE50ES	60	65	M52x2	M48x2	65	387	M27x2	20	—
140	166	70	80	100	60 / GE60ES	70	75	M60x2	M52x2	70	428	M27x2	20	—
150	178	75	85	105	60 / GE60ES	70	75	M64x2	M60x2	75	438	M33x2	22	—
160	194	80	90	110	60 / GE60ES	70	75	M68x2	M64x2	80	448	M33x2	22	—
180	219	90	100	125	70 / GE70ES	80	85	M76x3	M68x2	90	493	M42x2	25	—
200	245	100	110	140	80 / GE80ES	90	95	M85x3	M76x3	100	523	M42x2	25	—
220	273	110	125	160	90 / GE90ES	100	105	M95x3	M85x3	110	575	M42x2	25	—
250	299	125	170	180	100 / GE100ES	110	120	M105x3	M95x3	120	634	M42x2	25	—

Bore Φ	L15	L16	L14	Φ3	Φ4	Φ5	H3	L24	N-Φ6	L37	L38	S1
80	125	185	292	115	145	175	20	98	8-Φ13.5	>230<175+S	>215<205+S	55
90	140	200	275	130	160	190	20	89	8-Φ13.5	>230<170+S	>215<200+S	60
100	155	230	327	145	180	210	20	105	8-Φ18	>265<185+S	>245<225+S	80
110	170	245	342	160	195	225	22	107	8-Φ18	>270<200+S	>250<235+S	70
125	185	260	347	175	210	240	22	105	10-Φ18	>260<205+S	>240<245+S	55
140	200	290	383	190	225	260	24	121	10-Φ20	>305<225+S	>280<265+S	80
150	215	305	393	205	245	285	26	122	10-Φ22	>315<235+S	>295<275+S	80
160	230	320	403	220	260	300	28	122	10-Φ22	>315<245+S	>295<285+S	70
180	255	360	443	245	285	325	30	133	10-Φ24	>350<260+S	>325<305+S	90
200	285	405	463	275	320	365	32	146	10-Φ26	>370<220+S	>245<320+S	100
220	320	466	508	305	355	405	34	160	10-Φ29	As request		100
250	350	500	557	330	390	450	36	181	12-Φ32			105

XINGYU

HSG Earring Cylinder



XINGYU

Multi-stage hydraulic cylinder

- **TG Series**

**Max. Working Pressure:
31.5Mpa**





Multi-stage hydraulic cylinder

XINGYU™ MULTI-STAGE HYDRAULIC CYLINDER

MODEL DESCRIPTION

- **Intended Use:** Double-acting multi-stage telescopic applications
- **Temperature Range:** -40°F to 230°F
- **Piston:** Ductile iron ASTM A536 65-45-12
- **Seal retainer:** Ductile iron with drilled oil passages, ASTM A536 65-45-12 compliant
- **Tubes:** Precision honed steel barrels (multi-stage)
- **Rods:** Hard chrome plated
- **End fittings:** Ductile iron female clevis with pins & clips
- **Tube seals:** NBR O-rings with backup rings
- **Rod seals:** Deep-corrugated polypropylene B-lip seals
- **Rod wiper:** Snap-in polyurethane
- **Piston seals:** Hallite 755 with wear rings
- **Finish:** Black paint coating



1.14" length of thread on the first stage rod end (no room to adjust).
 3.15" length of thread for 8" and 16" ASAE (do not adjust below 1.625" length of the end).

MOLDEL CODE

2 **TG** × **95** × **600** - **16Mpa**

Number of stages
2:2 Stages
3:3 Stages
#: # Stages

Telescopic Hydraulic Cylinder

Bore
Max dia.
The first stage

Stroke

Working Pressure

TWO-STAGES TELESCOPIC HYDRAULIC CYLINDER SIDE LUGS

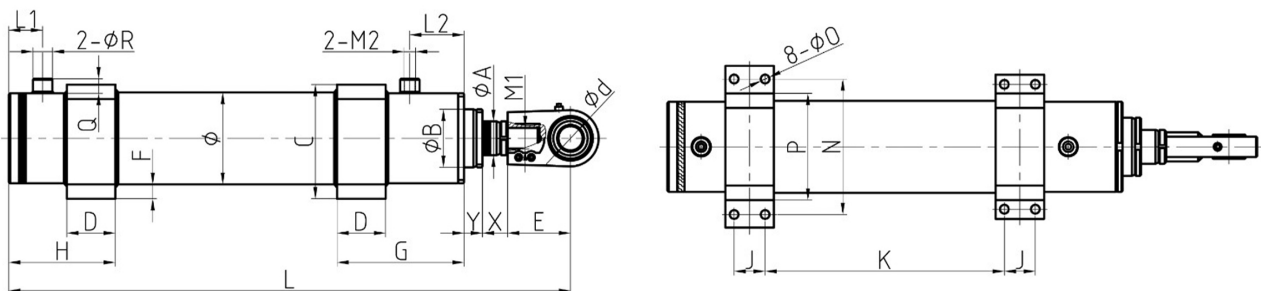

Model (Diameter x Stroke)	Rated Pressure /MPa	Maximum Pressure /MPa	Total trip	Installation distance	ΦA	ΦB	C	D	E	F	G	H	J
2TGI-95x600	10	15	600	580	32	63	118	50	65	15	131	110	32
2TGI-95x900	10	15	900	730	32	63	118	50	65	15	131	110	32

Model (Diameter x Stroke)	K	L1	L2	M1	M2	N	ΦO	P	Q	ΦR	Φ	Φd	X	Y
2TGI-95x600	247	35	56	M18x2	M12x1.5	140	9	110	15	20	95	25	26	19
2TGI-95x900	397	35	56	M18x2	M12x1.5	140	9	110	15	20	95	25	26	19

TWO-STAGE TELESCOPIC HYDRAULIC CYLINDER

TRUNNION

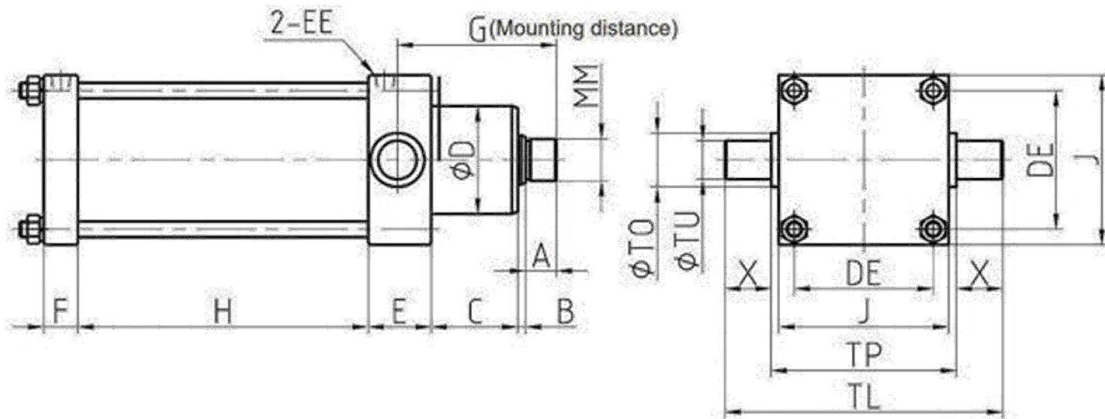

Model (OD.xStroke)	Operating Pressure(MPa)	Max Pressure (Mpa)	Stroke	G	MM	A	B	C	φD	E	F	H
2TGI-98x300	4	6	300	103	27x1.5	20	5	56	70	41	22	188
2TGI-98x600	4	6	600	103	27x1.5	20	5	56	70	41	22	338

Model (OD.xStroke)	J	DE	TP	TL	X	φTO	φTU	EE
2TGI-98x300	110	90	120	180	30	35	25	Z1/4
2TGI-98x600	110	90	120	180	30	35	25	Z1/4

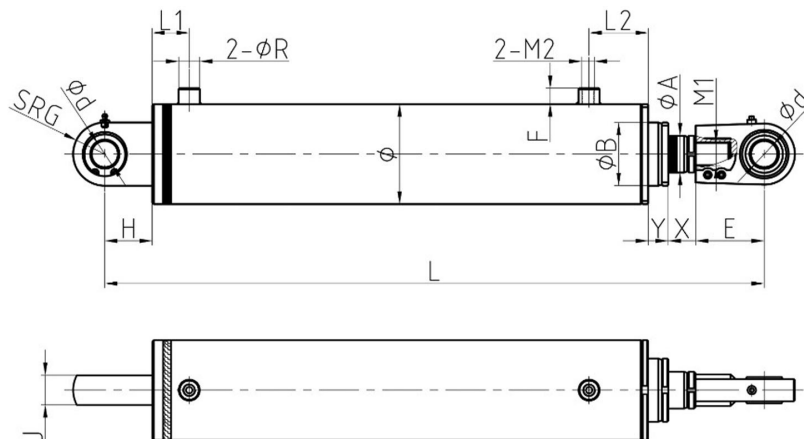

型号(直径x行程)	额定压力/Mpa	最高压力/Mpa	总行程	安装距L	φA	φB	E	F	SRG	H	L1	L2
2TGI-95x600	10	15	600	625	32	63	65	15	30	45	35	56
2TGI-95x900	10	15	900	775	32	63	65	15	30	45	35	56

型号(直径x行程)	M1	M2	φR	φ	φd	J	X	Y
2TGI-95x600	M18x2	M12x1.5	20	95	25	28	26	19
2TGI-95x900	M18x2	M12x1.5	20	95	25	28	26	19

【Hole end-top mount cylinders】

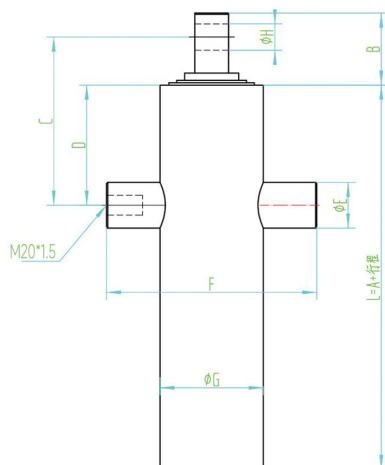

Model	Itinerary	level	Extend diameter				Thrust at 10 MPa	Cylinder installation dimensions							
			46	58	71	86		A	B	C	D	E	F	G	H
2TG-71-500	500	2		+	+		2600	100	60	140	100	38	175	86	22
3TG-71-750	750	3	+	+	+		1600	100	60	140	100	38	175	86	22
3TG-71-900	900	3	+	+	+		1600	100	60	140	100	38	175	86	22

【Hole end-top mount cylinders】

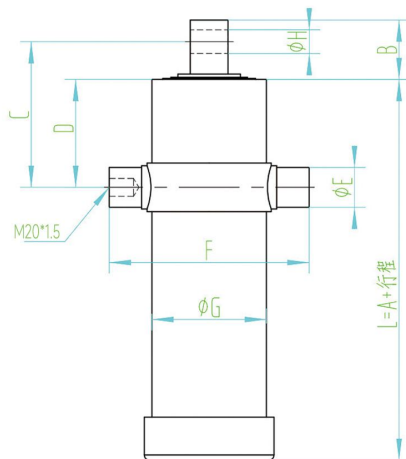

Model	Itinerary	level	Extend diameter				Thrust at 10 MPa	Cylinder installation dimensions							
			46	58	71	86		A	B	C	D	E	F	G	H
2TG-86-500	500	2			+	+	4000	115	60	140	100	38	176	106	22
2TG-86-750	750	3		+	+	+	2600	115	60	140	100	38	176	106	22

【Hole end-top mount cylinders】

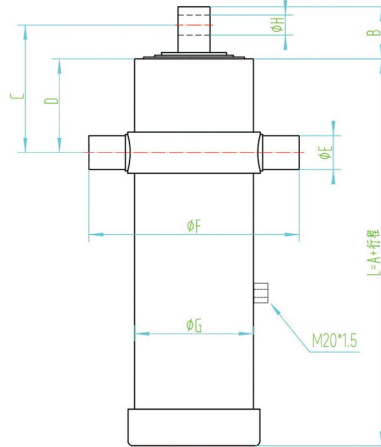

Model	Itinerary	level	Extend diameter				Thrust at 10 MPa	Cylinder installation dimensions							
			58	71	86	110		A	B	C	D	E	F	G	H
3TG-110-750	750	3		+	+	+	4000	120	60	140	100	38	230	130	22
3TG-110-1050	1050	3		+	+	+	4000	120	60	140	100	38	230	130	22
3TG-110-1350	1350	3		+	+	+	4000	120	60	140	100	38	230	130	22
3TG-110-1500	1500	3		+	+	+	4000	120	60	140	100	38	230	130	22

【Hole end-top mount cylinders】

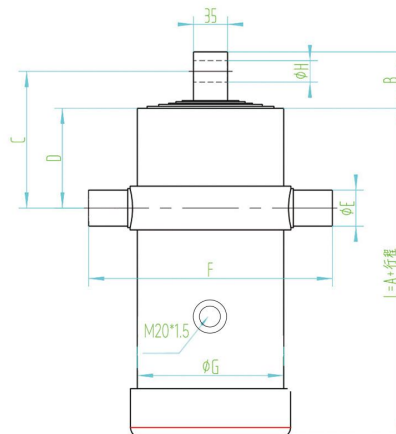

Model	Itinerary	level	Extend diameter					Thrust at 10 MPa	Cylinder installation dimensions							
			58	71	86	110	130		A	B	C	D	E	F	G	H
4TG-130-800	800	4		+	+	+	+	4000	120	60	140	100	38	250	150	22
5TG-130-800	800	5	+	+	+	+	+	2600	120	60	140	100	38	250	150	22



Tie rod cylinder

XINGYU™ TIE ROD CYLINDER

MODEL DESCRIPTION

- **Intended Use:** Double-acting tie-rod cylinder, general industrial applications
- **Temperature Range:** -40°F to 230°F
- **Piston:** Ductile iron ASTM A536 65-45-12
- **Seal retainer:** Ductile iron with drilled oil passages, meeting ASTM A536 65-45-12
- **Tube:** Precision honed steel
- **Rod:** Hard chrome plated
- **Tie rods:** High-strength carbon steel with nuts and lock washers
- **End caps:** Ductile iron / carbon steel, flange mount available
- **Tube seals:** Nitrile rubber O-rings
- **Rod seals:** Deep-corrugated polypropylene with B-lip design
- **Rod wiper:** Polyurethane, snap-in type
- **Piston seals:** Hallite 755, enhanced wear resistance with wear rings

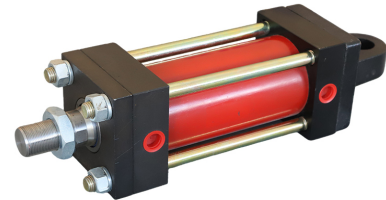

1.14" length of thread on rod end (no room to adjust).
 3.15" length of thread for 8" and 16" ASAE (do not adjust below 1.625" length of the end).

MOLDEL CODE

HOB		-	R	-	D	-	63	*	35	*	100		LB	+	Y	
Type	Non:Without Magnet R:With Magnet	Cushions	Bore	Standard	Max	Stroke	Cylinder Mounting	Piston rod end connecting type								
HOB Standard		Non: D:Both ends F: Head B: Cap	Φ40 Φ50 Φ63 Φ80 Φ100 Φ125 Φ150 Φ180 Φ200	Φ25 Φ30 Φ35 Φ40 Φ50 Φ60 Φ80 Φ100 Φ120	- Φ35 Φ40 Φ50 Φ60 Φ80 Φ100 Φ120	Standard stroke(mm) 50,100,150,200 250,300,350,400 450,500,600,700 800,900,1000	FA Head Flange FB Cap Flange LB Side End Angles TC Intermediate Fixed Trunnion TA Head Trunnion LA Side Lugs CA Detachable Eye CB Detachable Fixed Clevis CBP Detachable Fixed Clevis+PIN CAB CA+PIN+CB	Y Female Rod Clevis YP Female Rod Clevis + PIN I I Connecting KG Floating Connecting PHS Spherical Rod Eye T T Connecting H Welded Bushing A Adjustable Nut								
HOD Double rod																
Non:Standard																

FEATURES

Bore size	Φ40	Φ50	Φ63	Φ80	Φ100	Φ125	Φ150	Φ180	Φ200
Working medium	Clean Standard Hydraulic Oil								
Cylinder barrel material	20#Carbon steel/SUS304								
Operating pressure rang	0.8-14MPa(116-2000PSI)								
Temprature rang	-10 — +60(°C)								
Speed rang	0-300(mm/s)								
Standard piston length(PM)	30	35	35	50	60	65	65	90	90
Piston length(PM)1501-2500mm	60	70	70	80	100	100	100	140	140
Piston length(PM)2501-4000mm	120	140	140	150	180	180	180	200	200

XINGYU

HOB

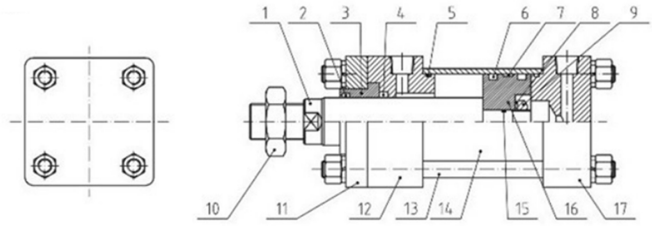

HOD

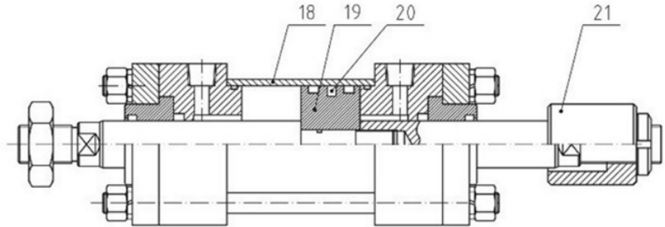

【Tie rod cylinder】

No	Part Name	Qty.	No	Part Name	Qty.	No	Part Name	Qty.
1	Piston Rod	1	8	Spring Washer Nut	1	15	O-Ring	1
2	Dust Wiper	1	9	Nut	1	16	Piston	1
3	Sleeve	1	10	Piston Rod Nut	1	17	Back Cover(Cap)	1
4	Rod Seals	1	11	Flange Cover	1	18	Cylinder Barrel	1
5	O-Ring	2	12	Head Cover	1	19	Piston	1
6	Port seals	2	13	Tie Rod	4	20	Magnetic Ring	1
7	Wear Ring	1	14	Cylinder Barrel	1	21	Adjustable Nut	1

Tie Rod Extended

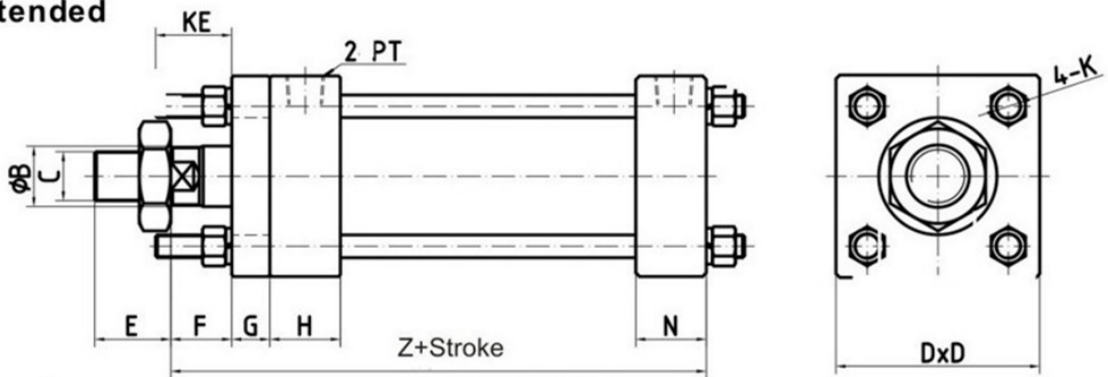

Standard HOB													
Bore	ΦB	C	D	DE	E	F	G	H	N	PT	K	KE	Z
Φ40	25	M22*P1.5	65	45	40	20	17	35	30	3/8	M10	30	156
Φ50	30	M26*P1.5	80	56	40	20	17	40	30	3/8	M12	40	166
Φ63	35	M30*P1.5	90	62	45	20	17	40	30	3/8	M12	40	166
Φ80	40	M30*P1.5	110	80	45	20	20	40	40	1/2	M16	60	194
Φ100	50	M40*P2.0	131	95	55	25	20	40	40	1/2	M18	60	209
Φ125	60	M50*P2.0	162	122	70	35	30	52	43	3/4	M22	70	255
Φ150	80	M70*P2.0	195	144	80	35	30	62	52	3/4	M24	70	274
Φ180	100	M90*P2.0	235	175	100	35	40	65	55	1	M30	70	315
Φ200	100	M90*P2.0	262	193	100	40	40	65	60	1	M33	70	325

Double Rod Cylinders

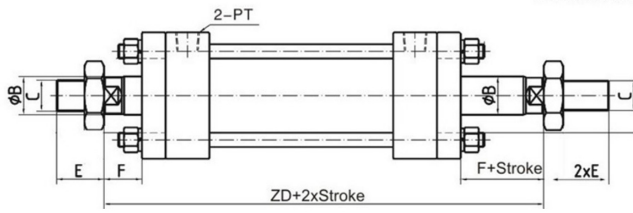

Double Rod Cylinders+Adjustable Nut

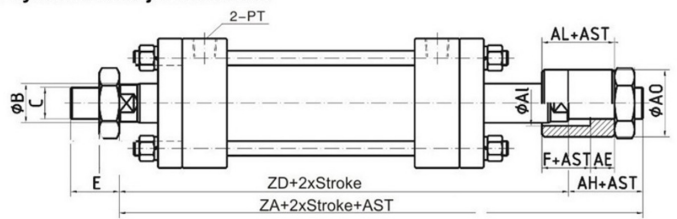

HOB,HOD								HOB,HOD		
Bore	φB	C	D	DE	E	F	PT	Z	ZD	K
φ40	25	M22xP1.5	65	45	40	20	3/8	156	198	M10
φ50	30	M26xP1.5	80	56	40	20	3/8	166	213	M12
φ63	35	M30xP1.5	90	65	45	20	3/8	166	213	M12
φ80	40	M30xP1.5	110	80	45	20	1/2	194	234	M14
φ100	50	M40xP2.0	131	95	55	25	1/2	209	254	M16
φ125	60	M50xP2.0	162	122	70	35	3/4	255	329	M22
φ150	80	M70xP2.0	195	144	80	35	3/4	274	344	M24
φ180	100	M90xP2.0	235	175	100	35	1	315	400	M30
φ200	100	M90xP2.0	262	203	100	40	1	325	410	M33

HOB+FA Head Flange

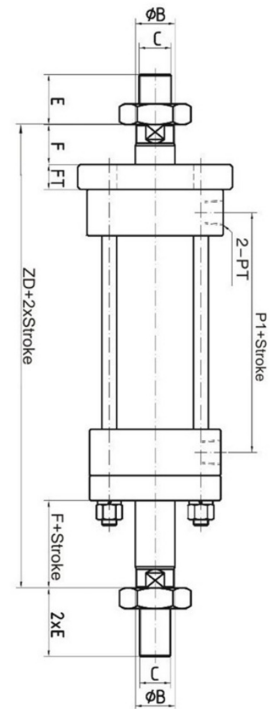
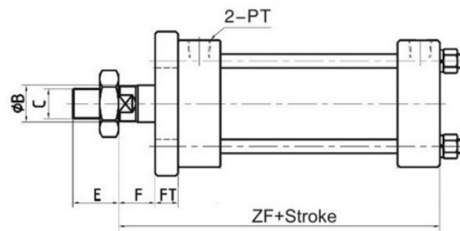
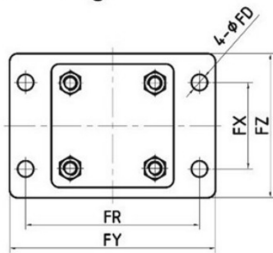

HOB+FB Cap Flange

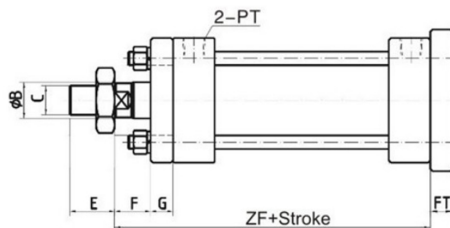
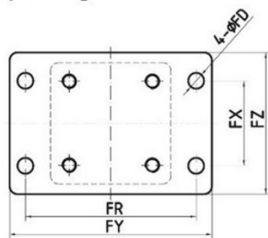

HOD+FA Double Rod Cylinders+Head Flange

HOB-HOD							FA+FB type					
Bore	φB	C	E	F	PT	ZF	φFD	FT	FR	FX	FY	FZ
φ40	25	M22xP1.5	40	20	3/8	156	12	17	93	50	115	75
φ50	30	M26xP1.5	40	20	3/8	166	14	17	110	56	150	85
φ63	35	M30xP1.5	45	20	3/8	166	14	17	126	68	155	95
φ80	40	M30xP1.5	45	20	1/2	194	18	20	152	75	190	120
φ100	50	M40xP2.0	55	25	1/2	209	20	20	180	100	220	140
φ125	60	M50xP2.0	70	35	3/4	255	24	30	222	122	280	170
φ150	80	M70xP2.0	80	35	3/4	274	28	30	260	155	310	206
φ180	100	M90xP2.0	100	35	1	315	35	40	315	188	375	250
φ200	100	M90xP2.0	100	40	1	325	35	40	355	207	425	272

HOB+TC Intermediate Fixed Trunnion

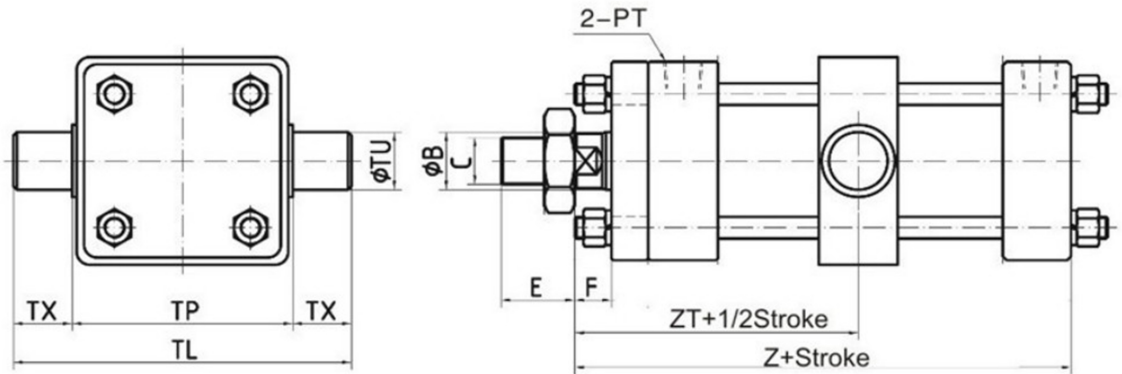

HOB+TA Head Trunnion

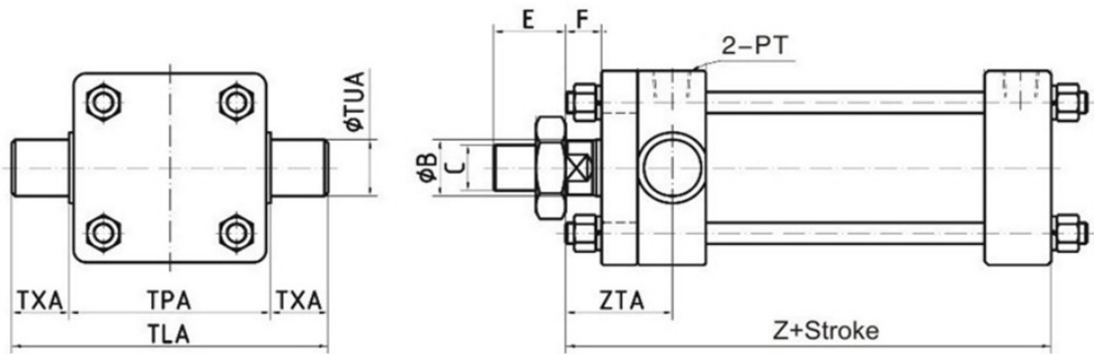

HOB						
Bore	ϕB	C	E	F	PT	Z
$\phi 40$	25	M22 x P1.5	40	20	3/8	156
$\phi 50$	30	M26 x P1.5	40	20	3/8	166
$\phi 63$	35	M30 x P1.5	45	20	3/8	166
$\phi 80$	40	M30 x P1.5	45	20	1/2	194
$\phi 100$	50	M40 x P2.0	55	25	1/2	209
$\phi 125$	60	M50 x P2.0	70	35	3/4	255
$\phi 150$	80	M70 x P2.0	80	35	3/4	274
$\phi 180$	100	M90 x P2.0	100	35	1	315
$\phi 200$	100	M90 x P2.0	100	40	1	325

Bore	TC Type					TA Type				
	ZT	ϕTU	TL	TP	TX	ZTA	ϕTUA	TLA	TPA	TXA
$\phi 40$	98	20	115	75	20	53.5	20	109	69	20
$\phi 50$	106	25	140	90	25	56	25	134	84	25
$\phi 63$	109	32	166	102	32	56	30	154	94	30
$\phi 80$	114	32	184	120	32	59	30	174	114	30
$\phi 100$	124	40	220	140	40	66	35	205	135	35
$\phi 125$	161	50	275	175	50	94	45	258	168	45
$\phi 150$	179	60	326	206	60	95	50	300	200	50
$\phi 180$	200	80	403	243	80					
$\phi 200$	205	90	452	272	90					

HOB+LA Side Lugs

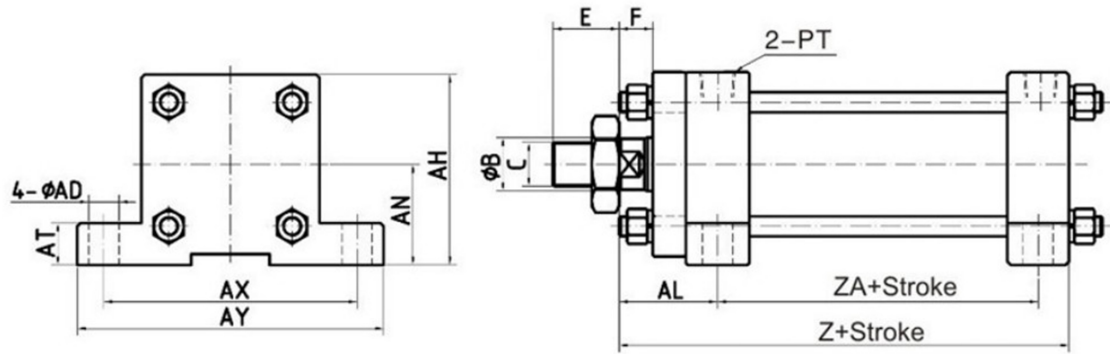

HOB+LB Side End Angles

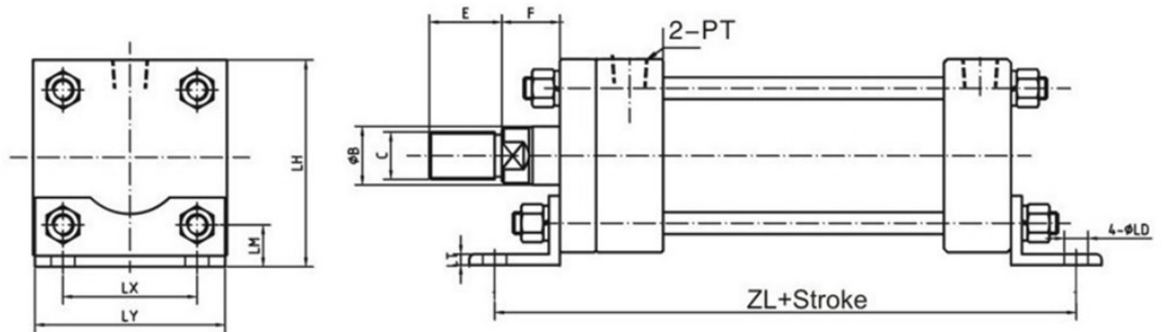

HOB					
Bore	ϕ B	C	E	F	PT
ϕ 40	25	M22 \times P1.5	40	20	3/8
ϕ 50	30	M26 \times P1.5	40	20	3/8
ϕ 63	35	M30 \times P1.5	45	20	3/8
ϕ 80	40	M30 \times P1.5	45	20	1/2
ϕ 100	50	M40 \times P2.0	55	25	1/2
ϕ 125	60	M50 \times P2.0	70	35	3/4
ϕ 150	80	M70 \times P2.0	80	35	3/4
ϕ 180	100	M90 \times P2.0	100	35	1
ϕ 200	100	M90 \times P2.0	100	40	1

Bore	LA Type									LB Type					
	ZA	Z	AN	AH	AL	ϕ AD	AT	AX	AY	ZL	ϕ LD	LM	LX	LY	LH
ϕ 40	88	156	37.5	70	53	12	14	90	112	212	11	24	45	68	79
ϕ 50	95	166	45	85	56	14	17	115	140	230	14	26	56	85	94
ϕ 63	95	166	50	95	56	14	19	128	156	234	16	26	66	95	104
ϕ 80	115	194	60	115	59	18	25	152	184	300	18	36	80	120	131
ϕ 100	123	209	69.5	135	66	21	27	178	210	316	20	44	95	140	159
ϕ 125	139	255	90	171	94	24	30	230	280	380	24	53	122	169	195
ϕ 150	153	274	113	208	95	28	35	270	325	399	28	53	144	200	220
ϕ 180	180	315	143	260	107	35	45	330	395	460	35	63	175	240	268
ϕ 200	183	325	161	292	112	35	50	360	430	475	35	74	193	265	301